

Suction Base Installation Guide

Step #1: Remove Transformer Main Body from Legs

1. Place Transformer on level surface and fully extend legs to prevent tipping.
2. Grasp Transformer HD by the main body with one hand and place other hand on the base legs as shown.
3. Firmly pull the main body away from the legs.

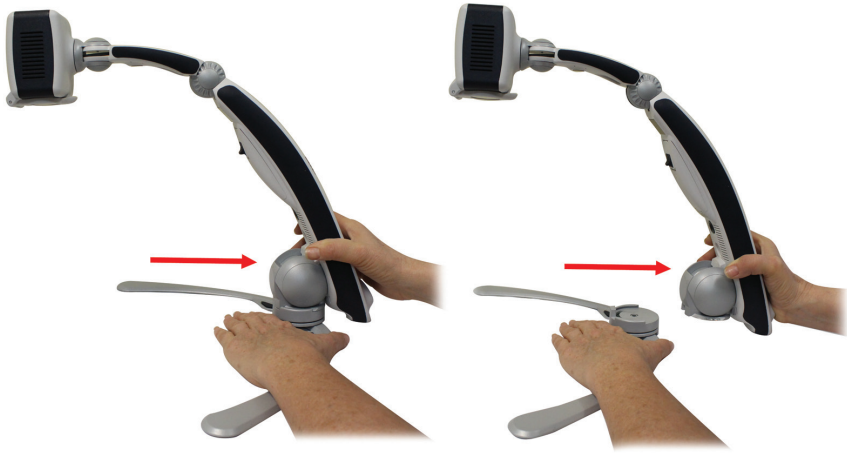

Suction Base Installation Guide

Step #2: Join Transformer Main Body To Suction Base

1. Take note of the shape of both the Transformer and Suction Base shape.
2. Slide main body into suction base until the built-in magnets make contact.

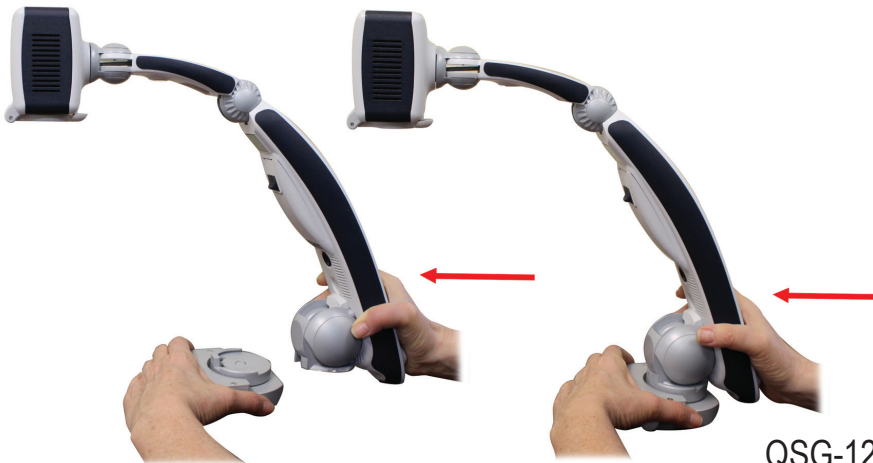

QSG-1200-00